

Name	Signatur	Datum	Artikelnummer	Oberfläche: Roh
Ch. Höfig	CH	30.03.2021	288.11255.VA	
Werkstoff:				Blattformat
1.4301 (X5CrNi18-10)				A4
Gewicht 1.990 kg		Maßstab: 1:5	Version: 1	Blatt 1 von 7

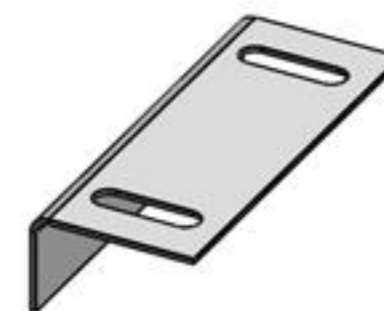

Name	Signatur	Datum	Artikelnummer	Oberfläche: Roh
Ch. Höfig	CH	30.03.2021	288.11255.VA	
Werkstoff:				Blattformat
1.4301 (X5CrNi18-10)				A4
Gewicht 0.688 kg		Maßstab: 1:5	Version: 1	Blatt 2 von 7

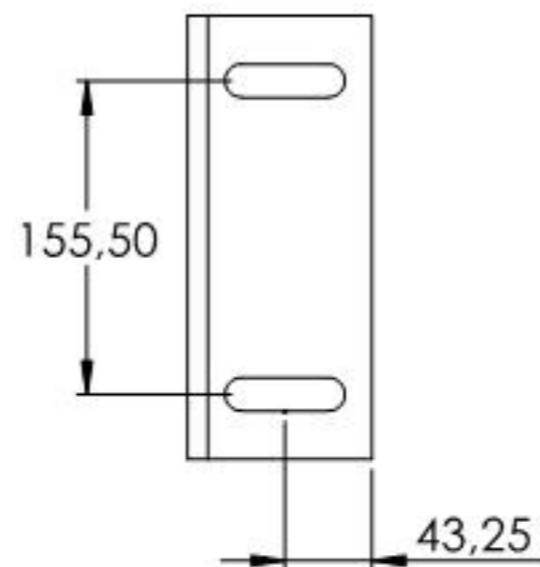
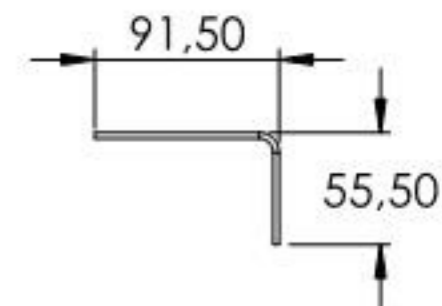
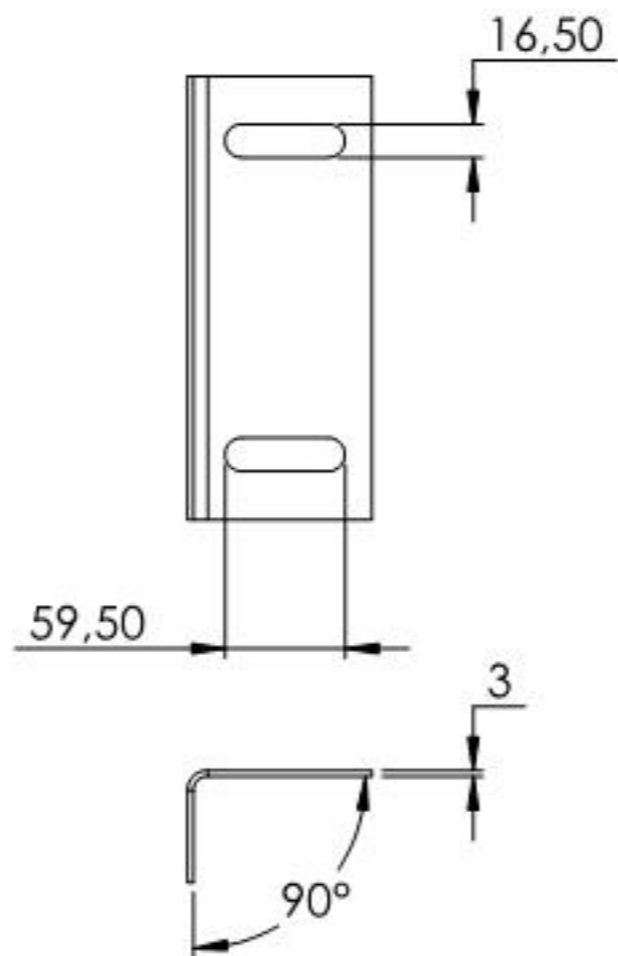
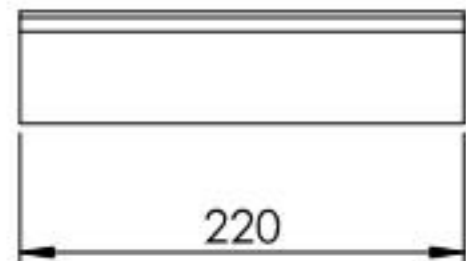
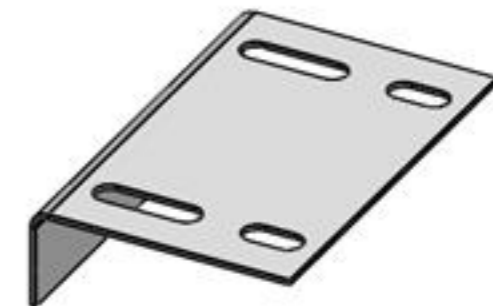
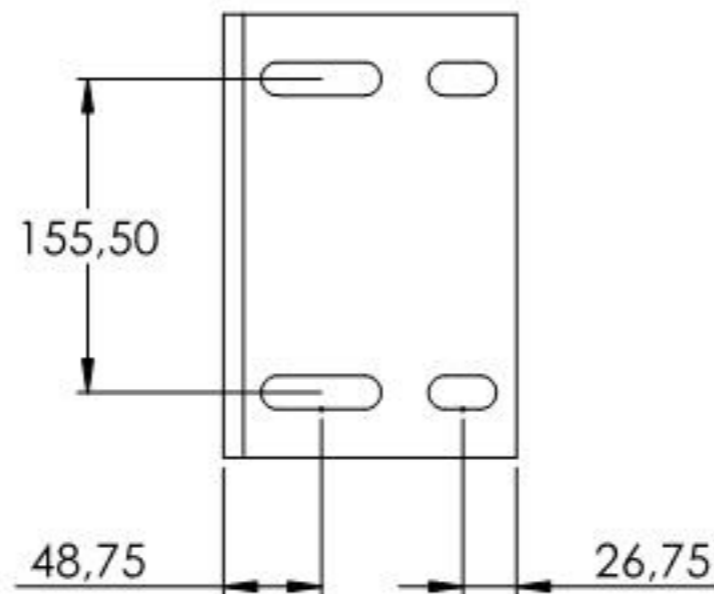
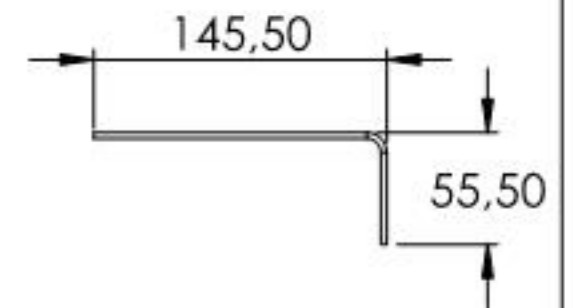
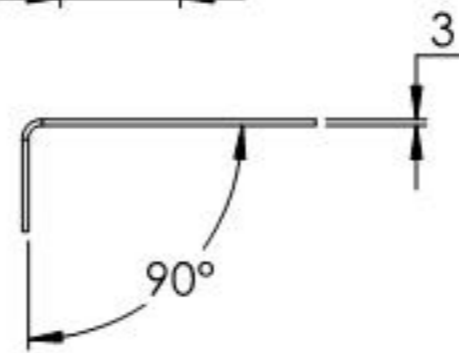
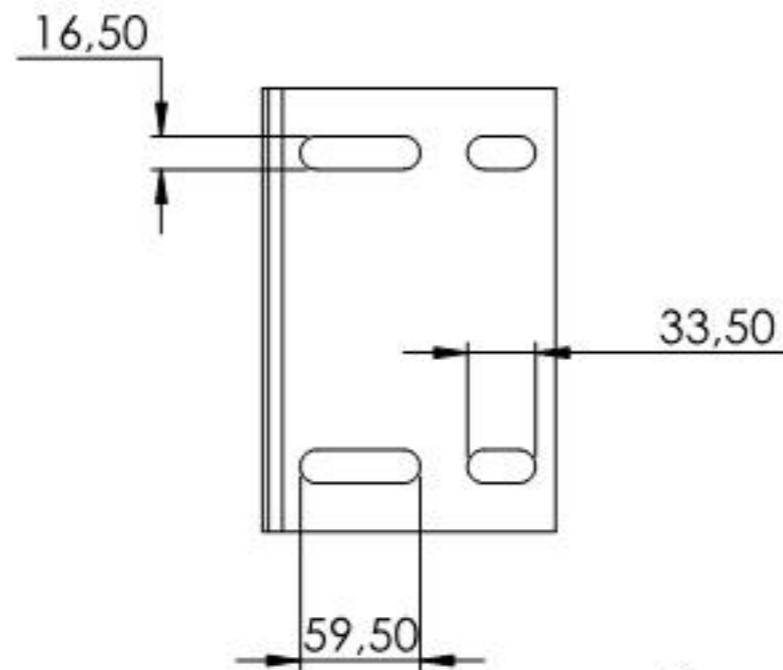
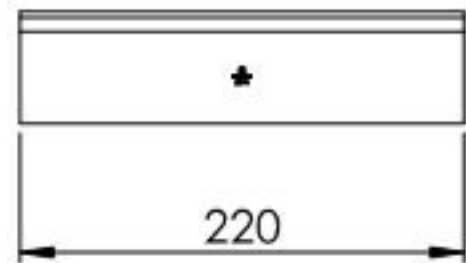

Name	Signatur	Datum	Artikelnummer	Oberfläche: Roh
Ch. Höfig	CH	30.03.2021	288.11255.VA	
Werkstoff:				Blattformat
1.4301 (X5CrNi18-10)				A4
Gewicht 0,946 kg		Maßstab: 1:5	Version: 1	Blatt 3 von 7